

RALLY ASSEMBLY MANUAL

BRAKE LINE INSTALLATION (Toe brakes option)

Install master cylinders to pedal system according to scheme below. Install master cylinders with reservoir to pilot pedals and cylinders without reservoir to co-pilot pedals. Remove master cylinders oil line caps and screw 90° fittings provided with 05-030-00/H brake system hardware kit.

Connect co-pilot master cylinders without reservoir to pilot master cylinder with reservoir as shown below with hydraulic tube provided.

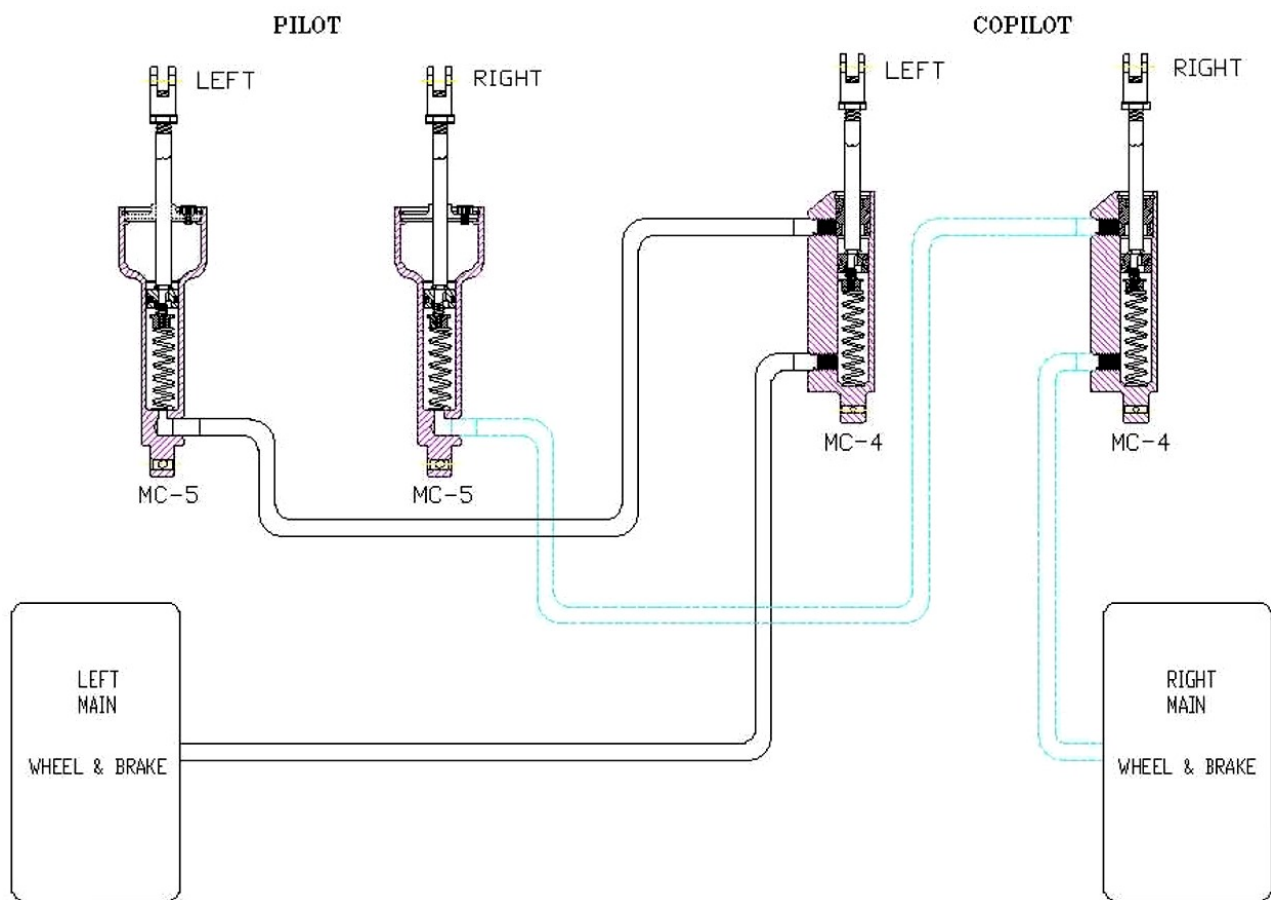

RALLY ASSEMBLY MANUAL

Connect master cylinders to brake line valves installed on central console (see “rear console” section), passing tubes through forward support and floor holes.

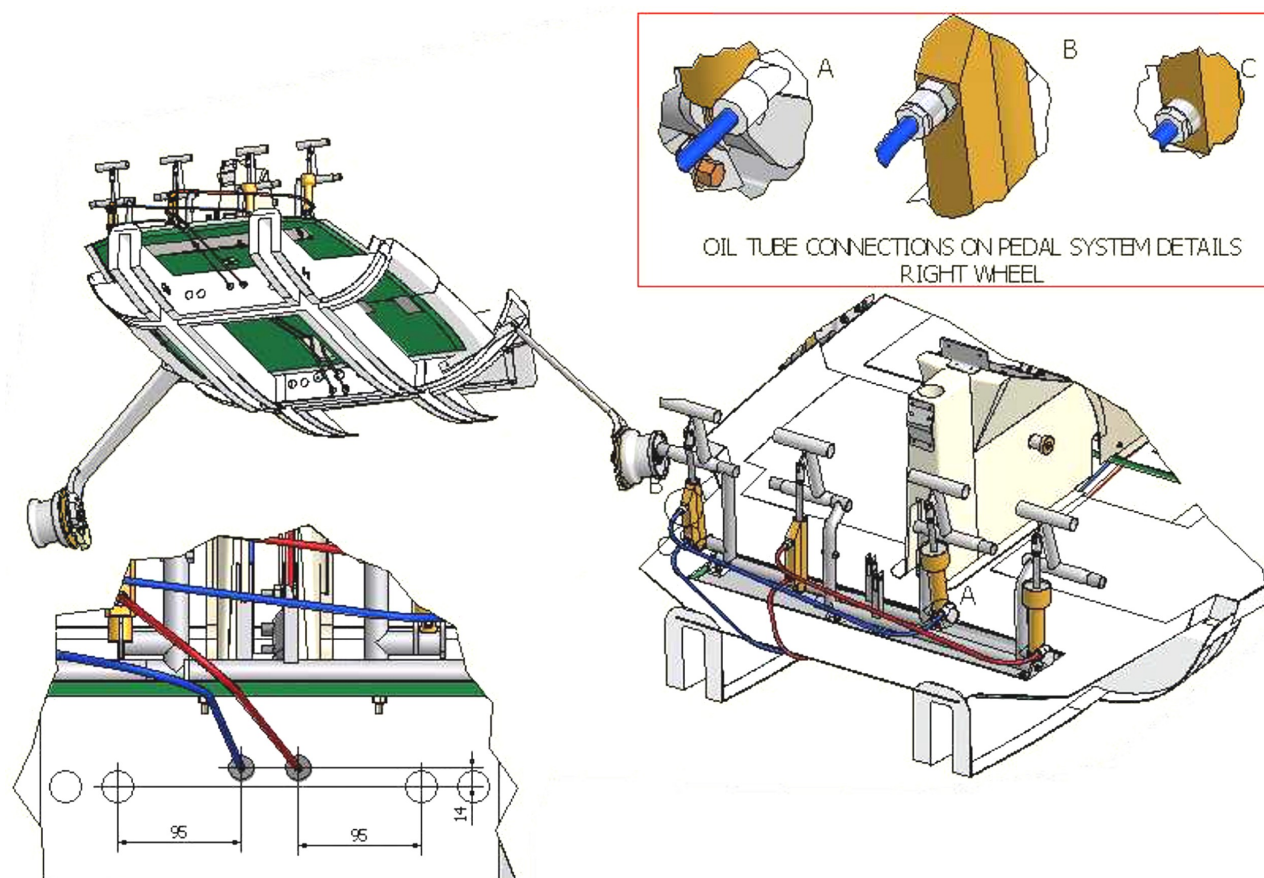

RALLY ASSEMBLY MANUAL

Connect brake line valves to main wheels, passing tubes through floor and main landing gear box, following dedicated main gear springs rear line till wheel brake caliper. For wheel installation see “Wheel installation” section in next pages.

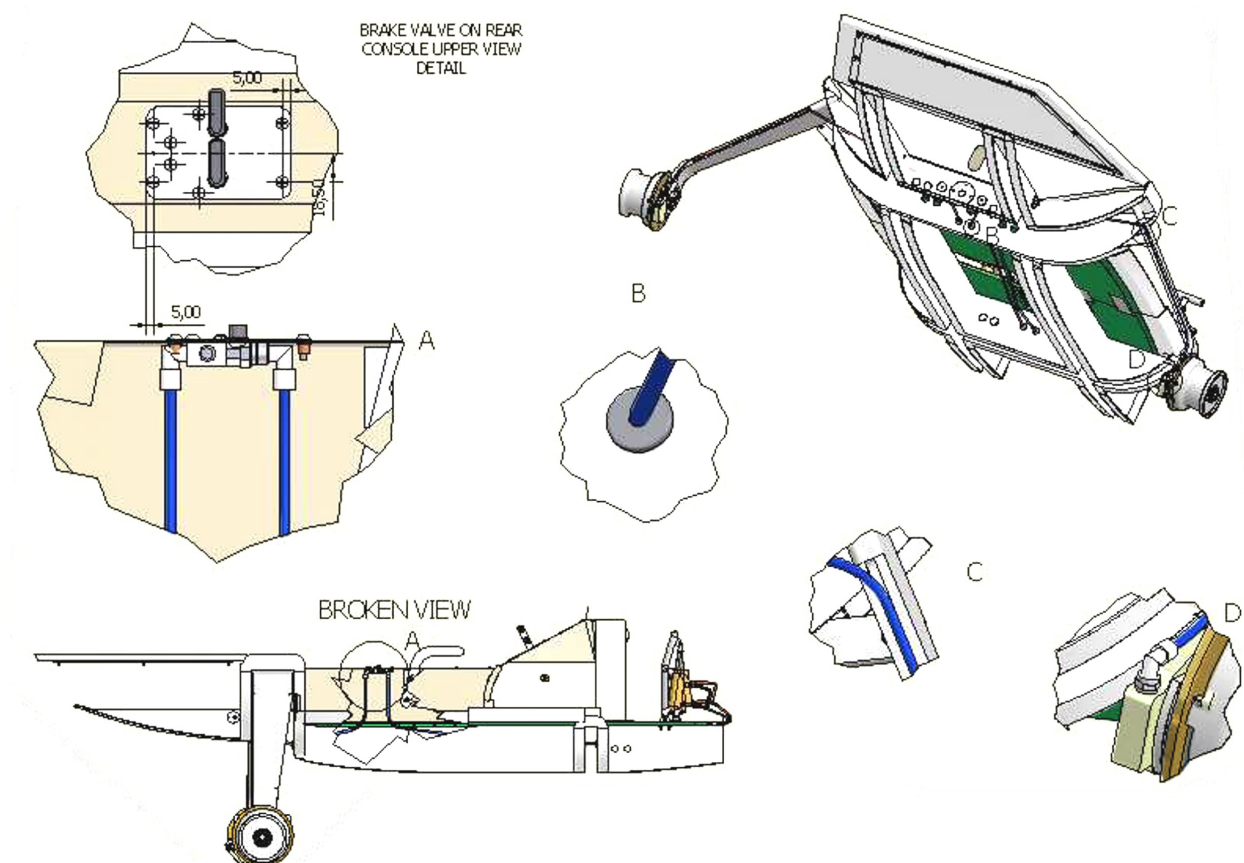

RALLY ASSEMBLY MANUAL

WHEEL INSTALLATION

MAIN LANDING GEAR

Position and align brake caliper to main gear spring as shown below. Insert axle through spring dedicated hole and screw brake caliper to spring with M6x20 bolt. Screw axle to spring with 25mm ring nut as shown below.

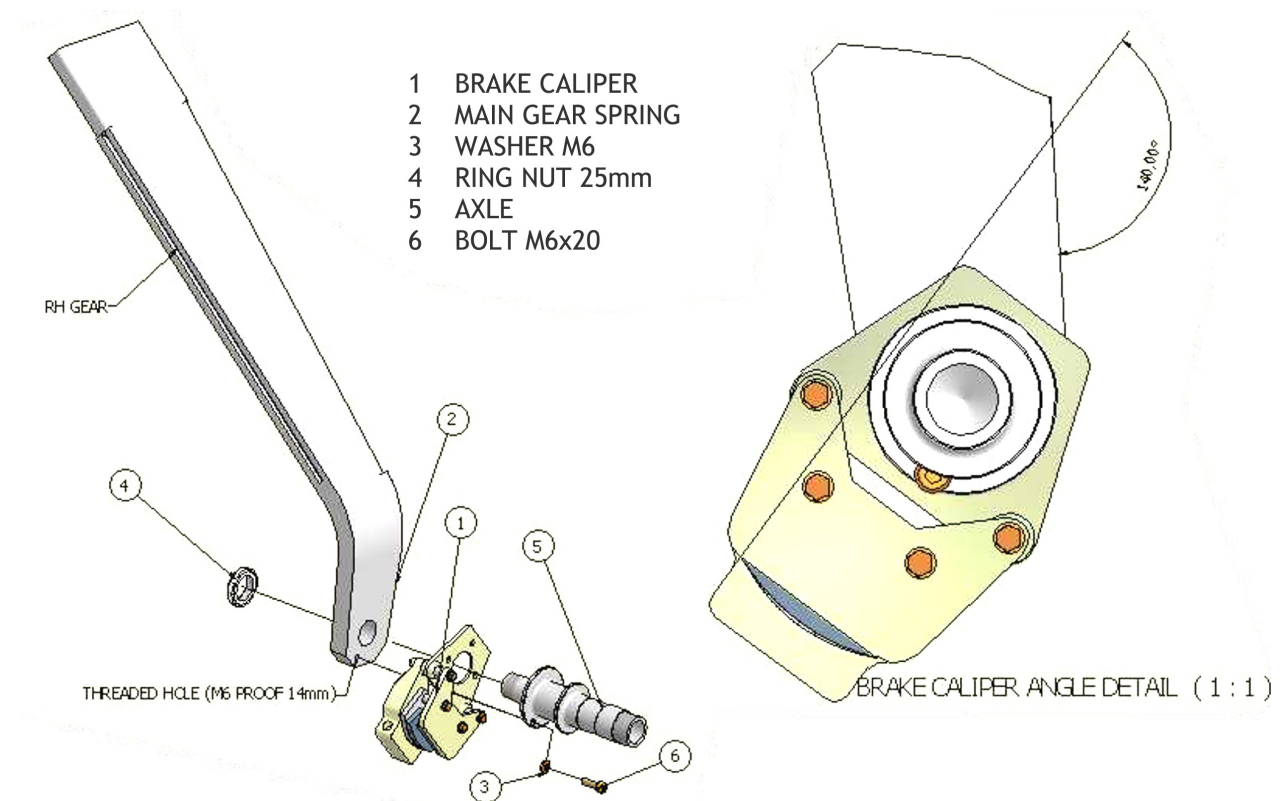

RALLY ASSEMBLY MANUAL

Install bearings provided with wheel and washer M20 to wheel rim as shown below. Insert and screw rim to axle with ring nut 30mm.

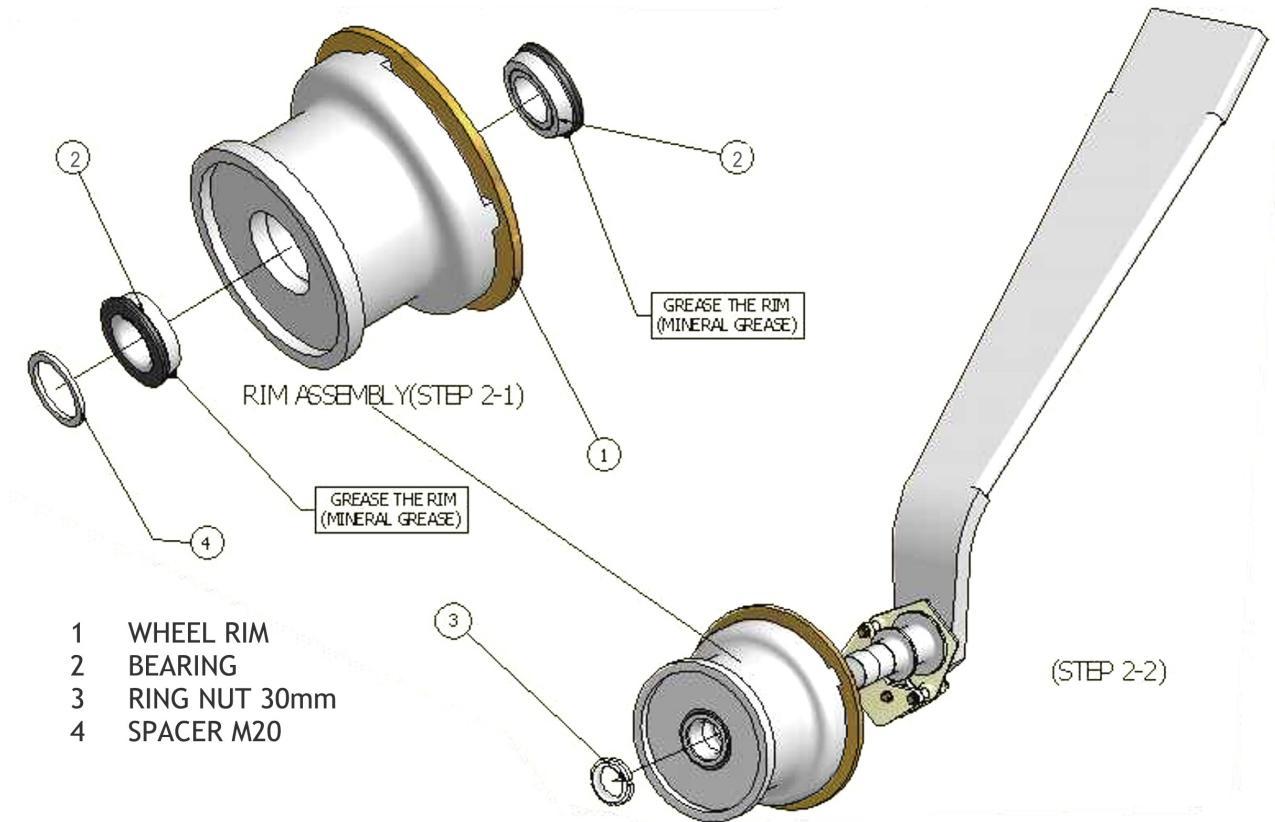

Screw 90° fitting (05-030-00/H brake system hardware kit) to brake caliper and connect to brake line hydraulic tube coming from central console brake line valves. (See "Brake line installation" section in previous pages).

RALLY ASSEMBLY MANUAL

WHEEL FAIRINGS INSTALLATION

NOSE GEAR FAIRING

Cut nose gear fairing 06-050-00 as shown below.

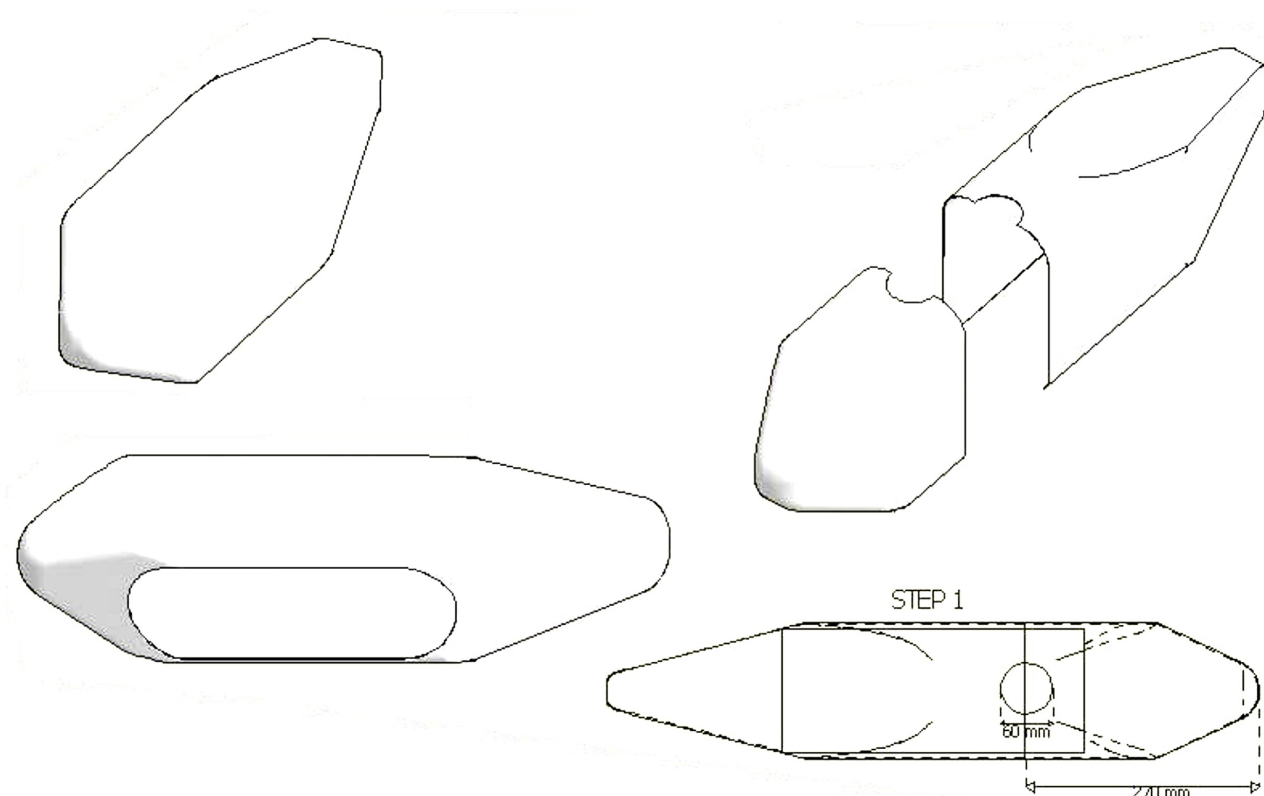

Glue with structural adhesive composite strips provided with wheel fairing to rear fairing section in order to join the two fairing sections and reinforcements 0236 in correspondence of nose gear axle.

Fasten the two fairing sections together and drill forward section in correspondence of composite stripes.

Install anchor nuts (06-050-00/H Nose gear wheel fairing hardware kit) to fairing rear section composite stripes where drilled with solid rivet 2.5.

Screw m/f shock absorbers to nose axle externally to nose gear fork, one for each side.

Screw nose gear fairing rear section to shock absorbers installed on axle with M6x16 bolts.

Screw forward fairing section to rear section with M4x10 bolts.

NOTE: insert rubber washers between washers or steel surfaces and composite.

RALLY ASSEMBLY MANUAL

MAIN LANDING GEAR FAIRING

Install wheel fairing support 0214 (05-050-00/H main landing gear wheel fairing hardware kit) to main landing gear spring as shown below with M6x16 bolts. Insert bush 0207 into axle and screw m/f shock absorber to bush.

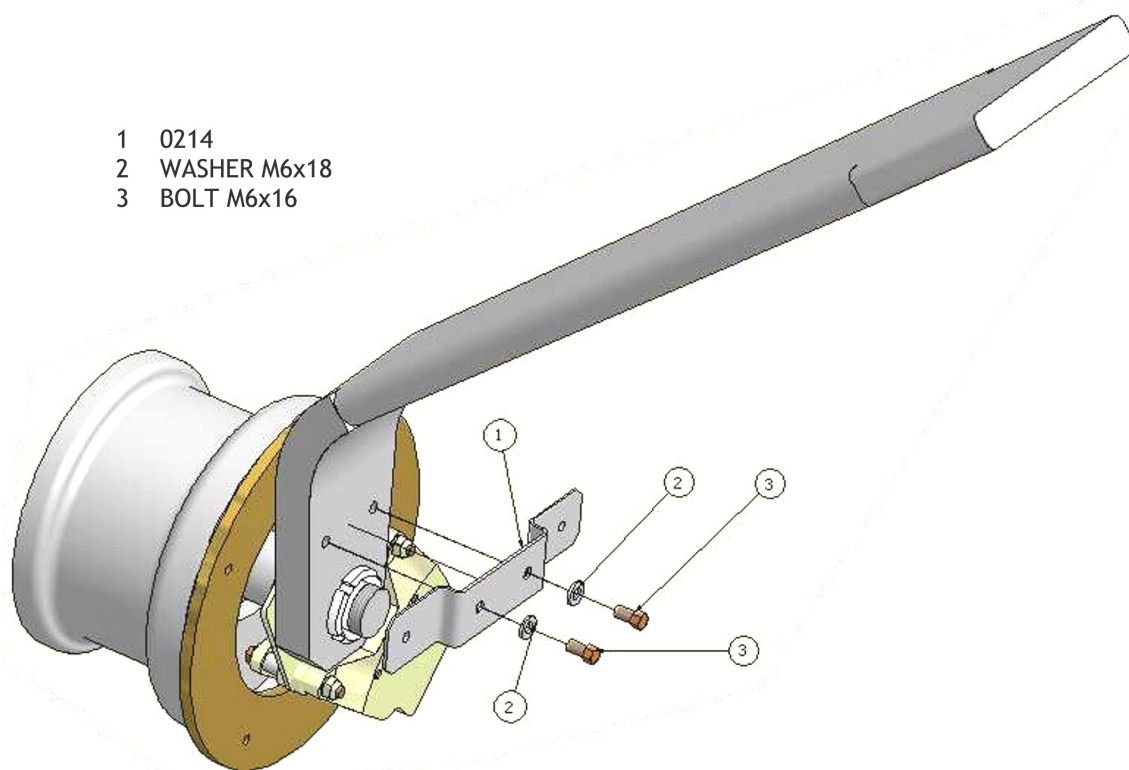

Drill wheel fairing internal section as shown below to fit spring.

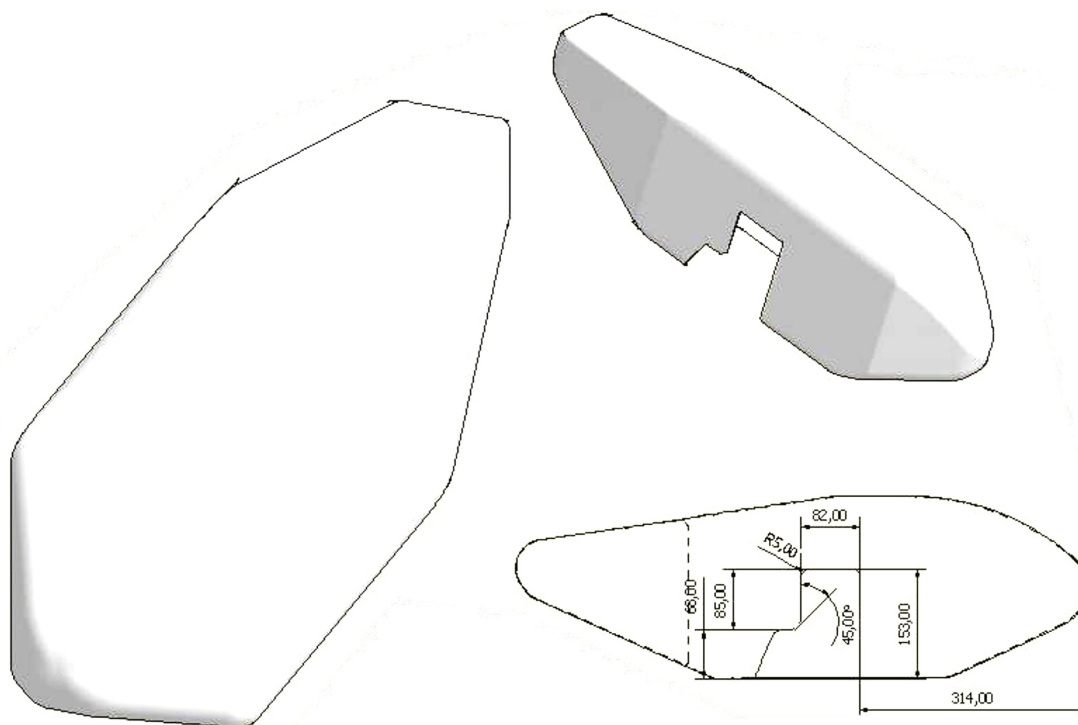

RALLY ASSEMBLY MANUAL

Position and align wheel fairing to wheel (to be performed with tyre installed and inflated), drill wheel fairing through wheel fairing support 0214 holes close to landing gear spring and drill in correspondence of wheel axle shock absorber hole from wheel fairing external section.

Glue with structural adhesive reinforcements 0236 internally to main landing gear wheel fairings 05-050-00 in correspondence of drilled holes and rivet with solid rivet 2.5 anchor nuts to reinforcements 0236.

Place wheel fairing on wheel and screw to wheel fairing support and axle shock absorber with M6x16 bolts.

NOTE: insert rubber washers between washers or steel surfaces and composite.

RALLY ASSEMBLY MANUAL

SEAT BELTS INSTALLATION

After seats have been upholstered and installed, install seat belts. Connect seat belt to bulkhead connections as shown below. Insert spacer SL107000-01/00 (01-290-00/H seat belts hardware kit) inside upper seat belt fitting, place seat belt fitting through bulkhead connection and screw with M6x30 bolt.

