

RALLY ASSEMBLY MANUAL

5. Pass cables through main landing gear box dedicated bushes as shown below.

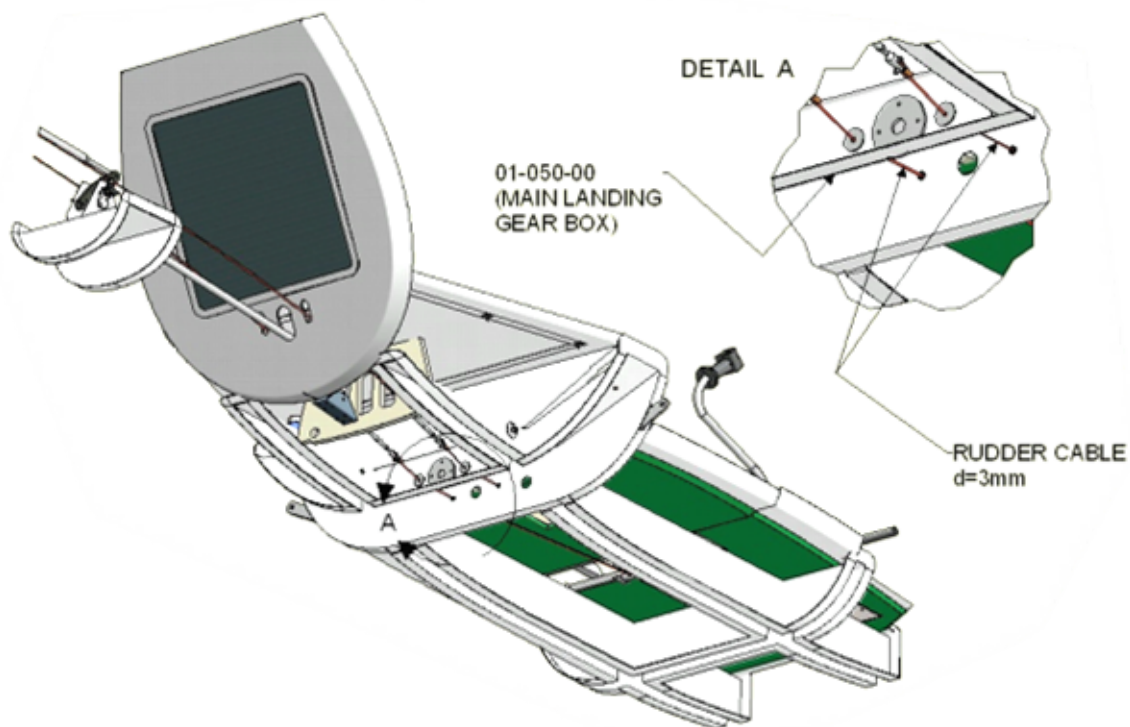

6. Pass cables through control stick dedicated holes as shown in detail A below.

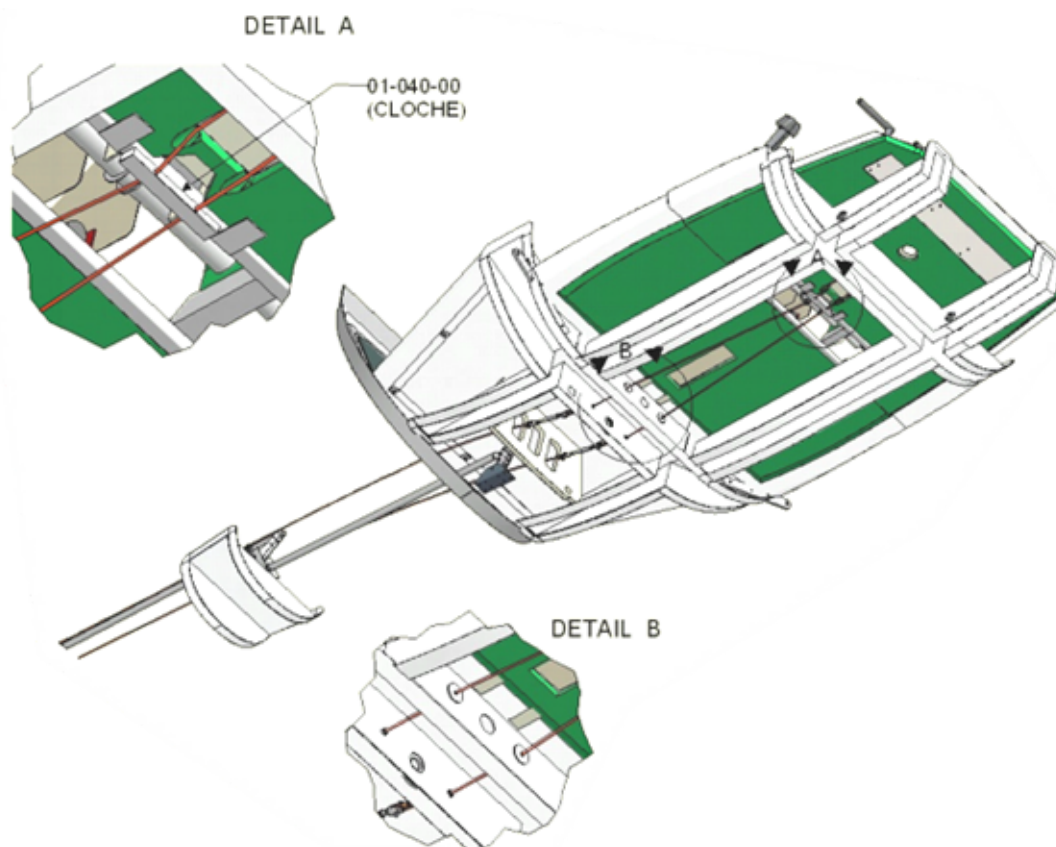

RALLY ASSEMBLY MANUAL

7. Pass cables through forward floor central hole. Fit cables to pedal system as shown in detail B below with M5 bolts.

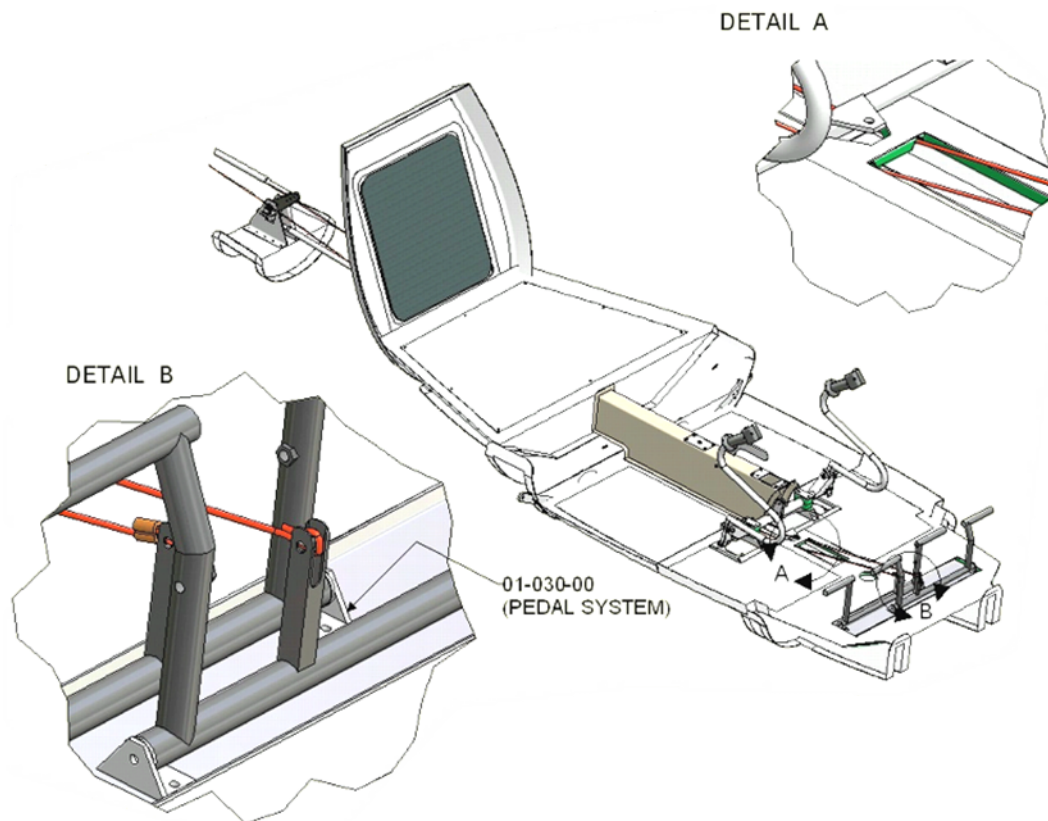

RALLY ASSEMBLY MANUAL

INSTRUMENT PANEL

Prepare instrument panel 01-240-00 cutting instrument plates dedicated housings. Install anchor nuts to fit the panels. Position instrument panel perpendicularly at 100mm from dash panel edge fixing fuselage side profile and dash panel profile. Glue with structural adhesive instrument panel to fuselage and dash panel. Clean and sand before gluing.



RALLY ASSEMBLY MANUAL

SEATS

Centre seat support on seat as shown below. Drill seat lower section through seat support fitting holes.



Centre seat support (or the adjustable seat support as shown in photo) on rear floor as shown below (remind the consider the rear console position) and mark position.

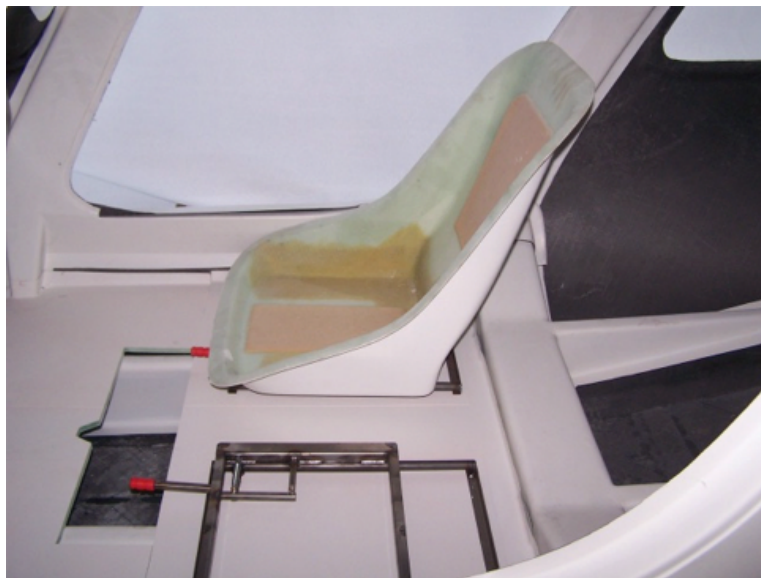

Remove seat from seat support and drill seat support fitting holes. Rivet anchor nuts to reinforcements 0260 using solid rivets 2.5. Glue with structural adhesive reinforcements 0260 to rear floor lower section in correspondence of seat support fitting holes.

RALLY ASSEMBLY MANUAL

FLOOR

Position forward floor 01-330-00/1 and rear floor 01-320-00/2. Adjust them to fit fuselage, main landing gear box and struts profile where required.

Centre forward console 01-250-00/1 on forward floor and rear console 01-250-00/2 on rear floor and mark position. Drill 2,5mm holes to fix consoles to floor successively. Remove consoles from floor.

Drill forward floor 01-330-00/1 to pass cables from forward console as shown below.

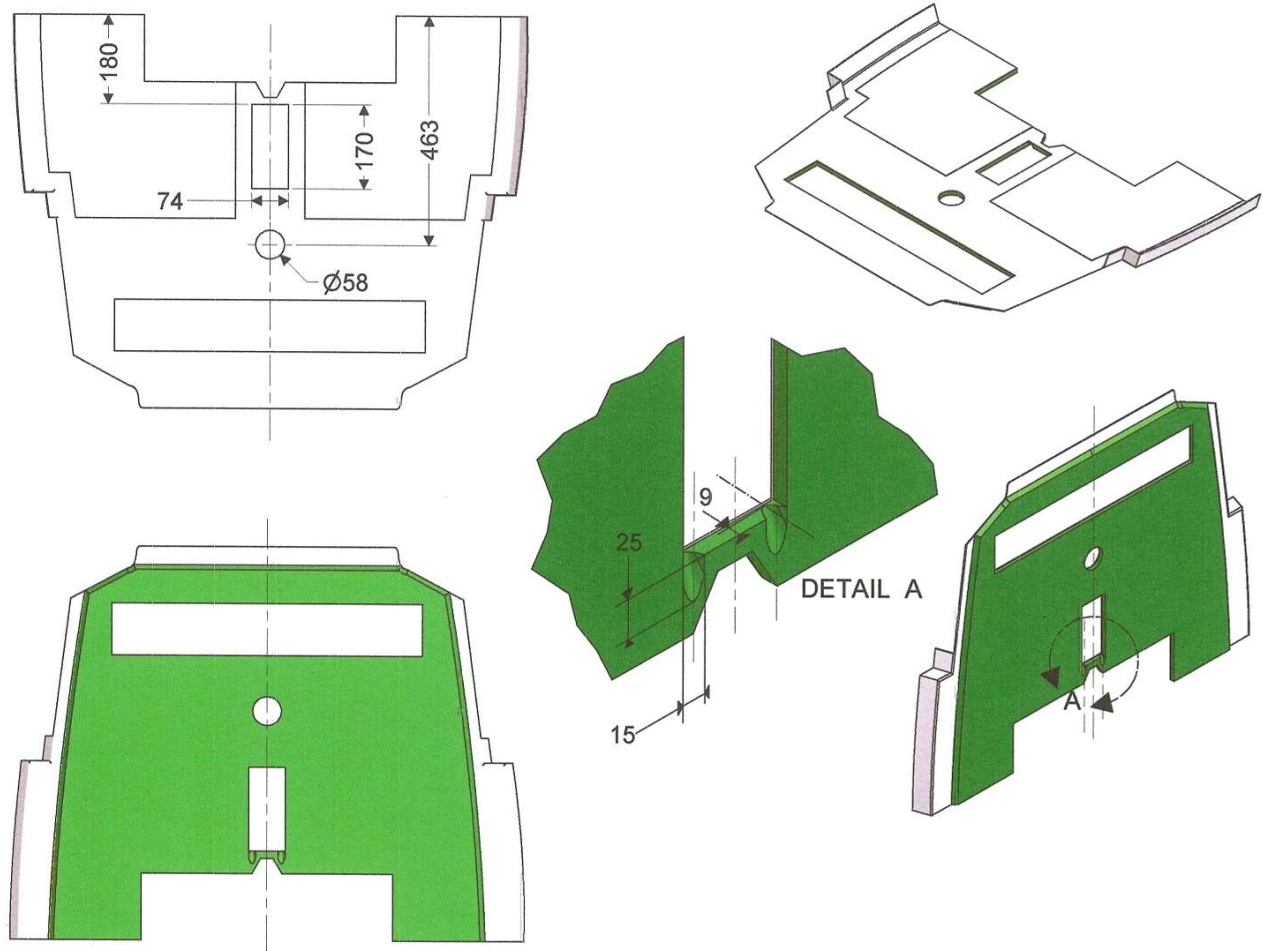

RALLY ASSEMBLY MANUAL

Drill rear floor 01-330-00/2 to pass cables from rear console as shown below.

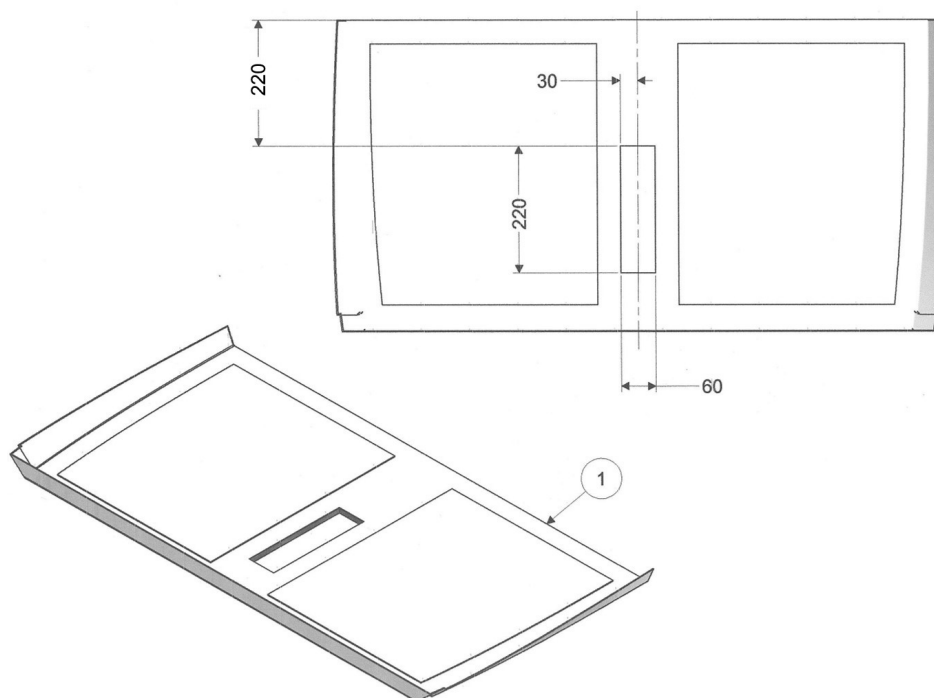

Glue composite reinforcements in correspondence of rear console fitting holes.

Glue with structural adhesive reinforcements 0259 and 0260 to rear floor lower section as shown below.

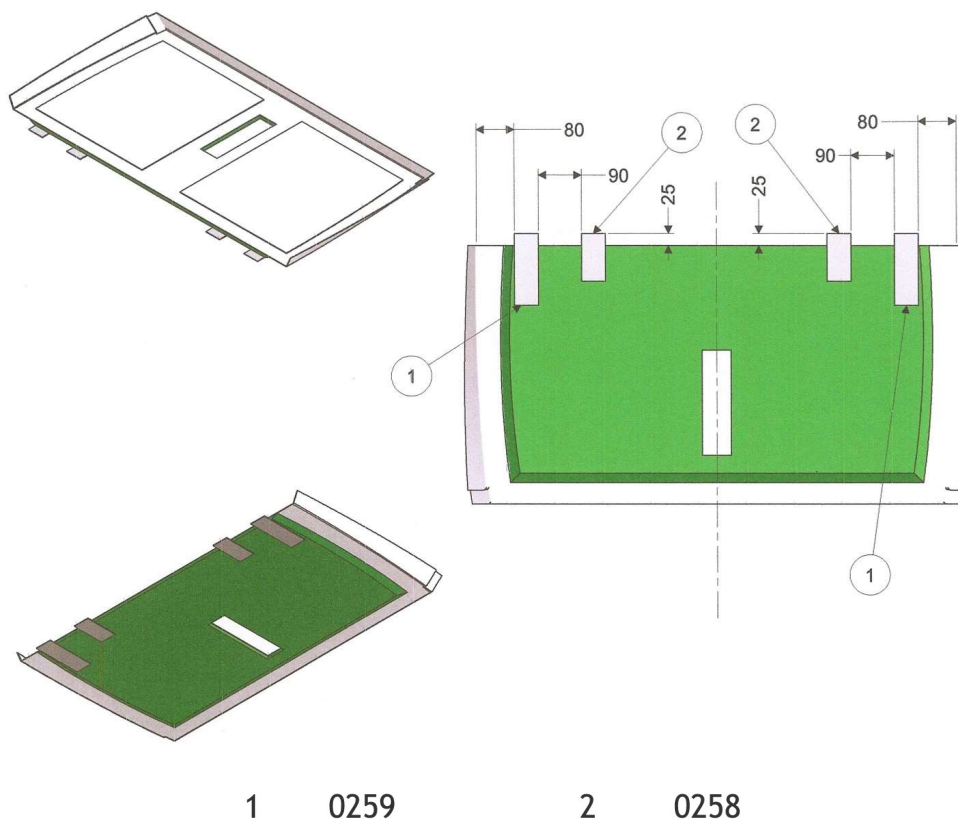

RALLY ASSEMBLY MANUAL

Now you can glue rear floor to main landing gear box, baggage plan structure and struts.
Clean and sand before gluing.

Glue the forward floor only after all rods, cables and tubes lines have been passed.

Tip: connect the elevator control rods and the aileron torsion rod to the control stick and pass the rudder cables before gluing the forward floor.

RALLY ASSEMBLY MANUAL

CONTROL STICK

Pass rudder cables through control stick dedicated holes. Fit Control Stick to forward support.



Now you can connect control stick to ailerons torsion rod through the two end rods as described in “Connecting the ailerons controls cables to the Control Stick” section and make final regulations.